

SETTING OUT - NOTE FOR CONTRACTOR
 IT IS THE RESPONSIBILITY OF THE CONTRACTOR TO CHECK ALL SETTING OUT INFORMATION (LEVELS, DIMENSIONS, COORDINATES, ETC.) INDICATED ON THIS DRAWING FOR THE WHOLE OF THE WORKS PRIOR TO COMMENCEMENT OF THE WORKS AND RECORD THE RESULTS ON A COPY OF THE DRAWING. ROCK TOWNSEND SHALL BE NOTIFIED OF ANY DISCREPANCIES AND NO WORK SHALL BE COMMENCED UNTIL FURTHER INSTRUCTIONS ARE RECEIVED IN WRITING.

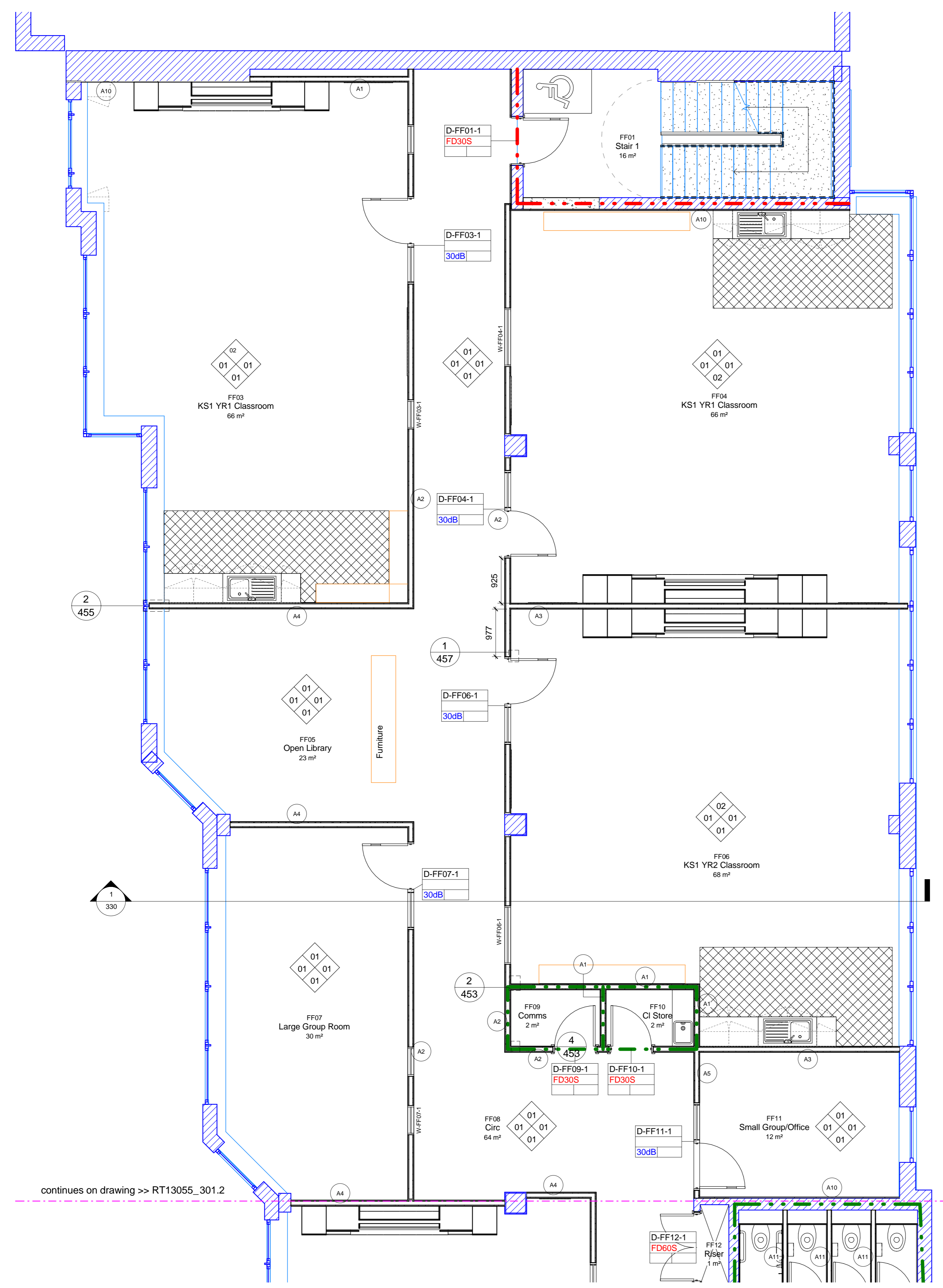

continues on drawing >> RT13055_301.2

- Existing
- - - Demolition
- New Construction
- Client Supply

- FINISHES KEY:**
- 01. Emulsion paint. Specification Reference M60/110 or M60/150 eggshell finish to corridors, stairs and main hall. Colour : Off White. Dulux 10BB 83/006
 - 02. Emulsion paint. Specification Reference M60/110. Colour : Grey.

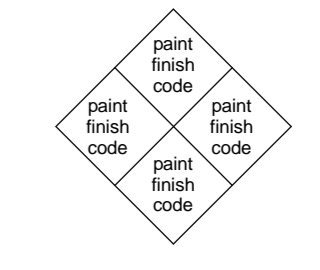

- FIRE RATING KEY :**
- FD30
 - FD60

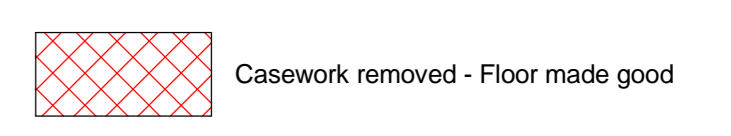

NOTES:
 Please refer to DWG 453 - Partition Types for wall types

REVISIONS	DATE/DRAWN
P8	GAs amended in line with Exova report 020915 07/09/15 RS
P7	GAs changed to 1:50 to add fire ratings, acoustic ratings, wall types 26/08/15 PB
P6	FF21/FF22 switched, FF15 WC added 29/07/15 PB
P5	Classroom Layout & Room No. updated 23/07/15 PB
P4	General Update 13/07/15 PB
P3	General Update 01/06/15 PB
P2	General Update 30/06/15 PB
P1	Initial Issue 29/06/15 CH

KEYPLAN	
PROJECT	St Jerome School
	Station Road, Harrow
DRAWING TITLE	GA Plan
	Level 1 West
DATE	26/06/15
SCALE	As indicated @ A1
STATUS	Proposed
JOB NO.	15028
DRAWING NO.	301.1
	REVISION P8

www.rocktownsend.co.uk

Rock Townsend